

PARENTHESIS

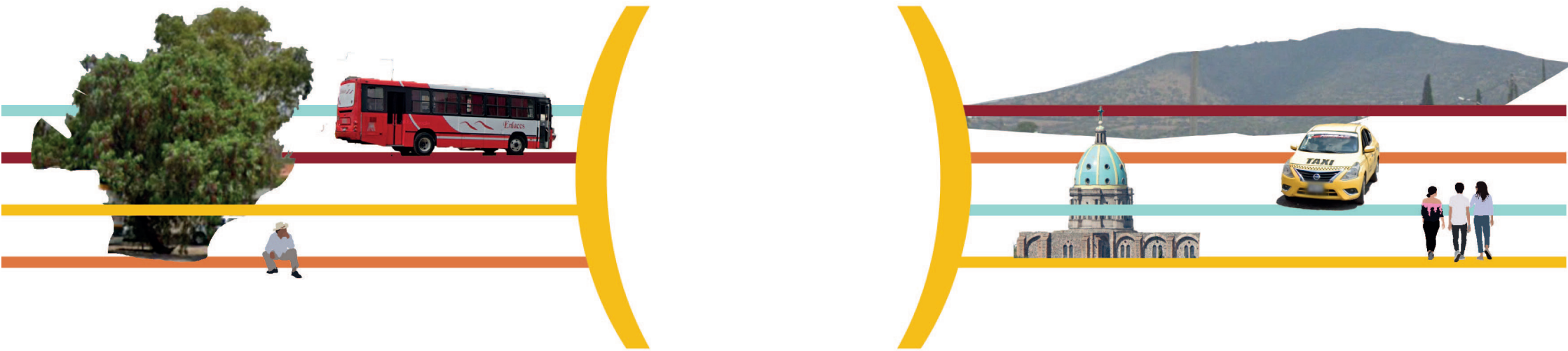

pause and ((re))connect

In this dynamic, fast-paced environment, we want to offer the chance for the community to pause and admire the natural qualities that are given to them such as the mountains and the nearby river. We also seek to enhance the connections between everyone as well as with their culture and daily commutes.

We offer you PARENTHESIS.

CONTEXT

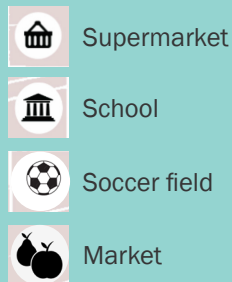
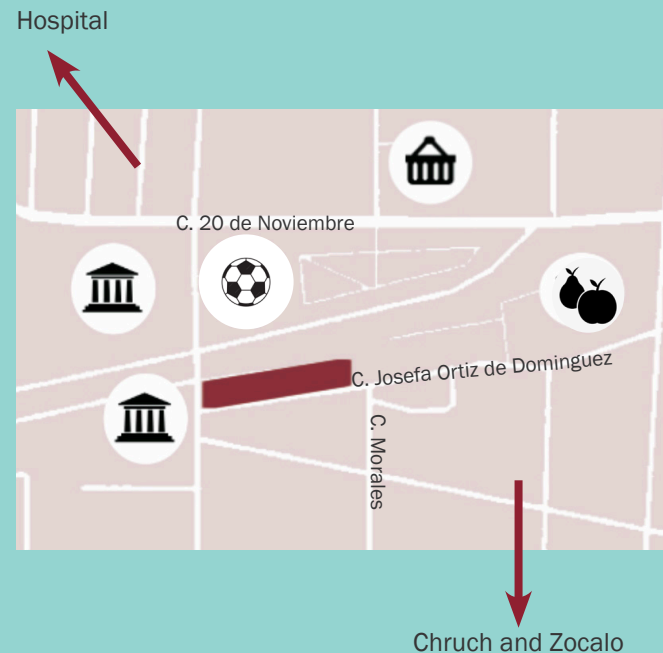
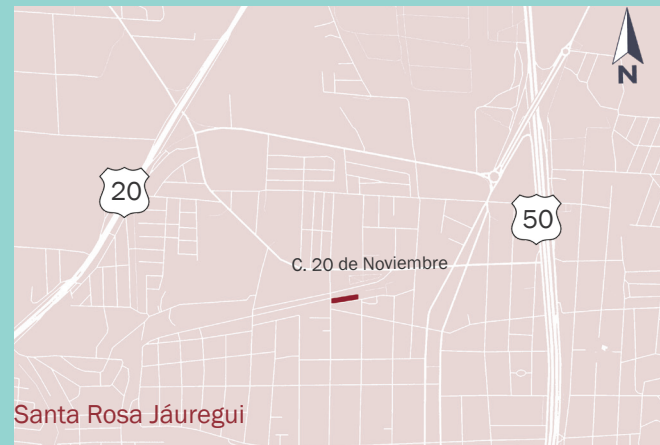

Querétaro is a Mexican state located North of the capital. It is within the industrial core of the country, it is also recognized for its agriculture and its mountains. Santa Rosa Jáuregui is in the north-west part of this state. It serves as the entry point to the region of Santiago de Queretaro and as the transitional point between the rural communities and the city.

The CETRAM Santa Rosa Jáuregui is an important transportation hub used by residents coming from the rural areas of this northern part of Querétaro. It is a place where different means of transportation including buses, taxis, pedestrians, and bikes converge and interact.

The area of intervention is situated at the end of Morelos Street, one of the first street layed out in the city. It was once at the very edge of urban Santa Rosa. However, it now plays a strategic role within the region. It is surrounded by important activities such as medical services, schools, the main market, stores, and public places. It is also a five-minute walk from the historical center of Santa Rosa. This node has been part of the daily practices of those commuting for over 25 years. It is strongly related to the commercial street where our proposition lays.

Josefa Ortiz de Domínguez Street is a space that generates a dynamic flow of transit all day long. At the same time, this space is also a waiting area for the bus and taxi drivers and their clients. They need this place to take a break between their rides. As a result, this place is not only a transit node but also a resting place, a parenthesis in time.

MALLEABILITY



During the week, workers, students and people in transit use the space. On Sundays, however, the parking lot on the East corner becomes a market bustling with merchants and customers from the surrounding regions. These various uses reflect the temporality and the mixed uses of the space.

The multitude of different spaces in time allows us to imagine ways to complement each of the uses. The whole area can become a place where more meaningful social interaction can bloom.



The area is highly mineralized. Not only does this generate a heat island effect, the design of the place, structured around vehicular transportation, does not include place for the people who experience the site daily. The ancient river could be a link that brings freshness to the site, but it is actually polluted and left behind.

The tree that can be seen in the picture above is the only shaded space where people can hide from the Sun in between their commuting. Everywhere else, heat is intensified by the dark asphalt.

VULNERABILITY

We have identified some main issues that need to be addressed in order to make the reality of PARENTHESIS happen.

The non-programmed spaces enhance conflicts between uses.

There is no designated space to rest or wait comfortably.

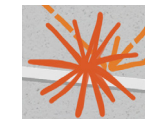

Chaotic spaces



Non-programmed movements



Tree as the only shaded space of the site



VISION

The users of this central node are naturally guided through a green pathway allowing them to connect to their daily practices, the landmarks and the environment.



INTERVENTIONS

We can separate this vision into short- and long-term guidelines.

Offer a shaded oasis to rest and get together comfortably.

Set apart the different uses of the space to ensure safety for active mobility users.

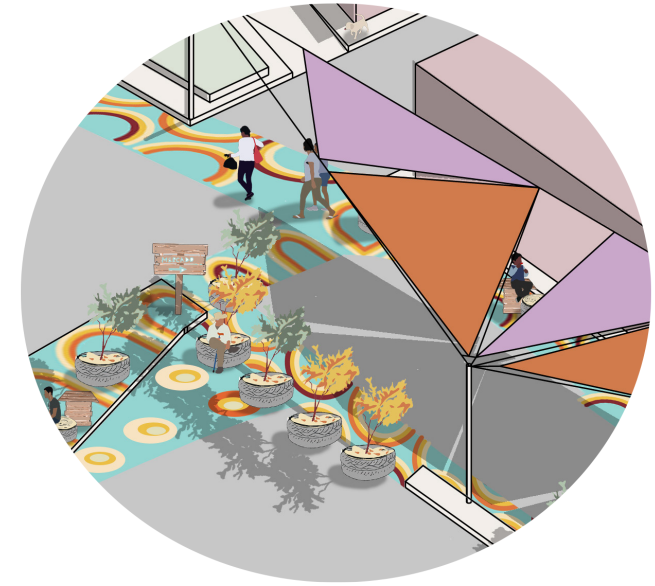

In the long term, we aim to

Create anchor places for people throughout the desired paths.

Connect interventions to reclaimed natural elements.

FURNITURE

The following set of furniture are low-cost and are inspired by their environment. The recuperation of tires remind the transit function of the space, while the wooden materials such as the huacal are also used by merchants during the sunday market to storage their merchandise. The use of wicker (mimbre) reminds its importance in Querétaro culture.

Bench

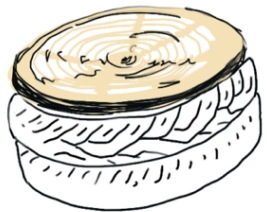

Function: Meet-up / Rest

Material: Tires / Wicker (Mimbre)

Benches give people a place to sit in between their daily paths. The tires can be painted to add colour.

Planter



Function: Greening / Delimit the pedestrian space

Material: Tires / plant

Delimit spaces and add vegetation to a highly mineralized context.

Table



Function : Meet-up / Rest

Material: wood panels

Workers and other users of the space can use the table to pause, eat and to chat.

Bike rack



Function : Transit

Materials : Wood Panels

Giving the people that use their bike for the transit a parking space.

Garbage bin

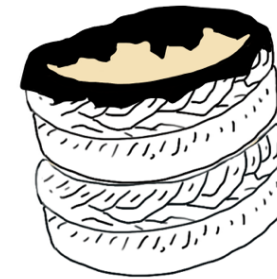

Function: Keep the space clean

Material: Tires

Allowing a space for garbage will ensure that the space is kept clean by the community. The tires can be painted to add colour.

Sign



Function: Localize

Material : Wood panels

Showing the local interests located near CETRAM Santa Rosa.

FURNITURE

Asphalt paint



Function: Delimit the pedestrian space

Materials : road marking paint

Guide users in their transit, while also solidifying the identity of the place. Painted easily with stencils.

Triangle sunshade

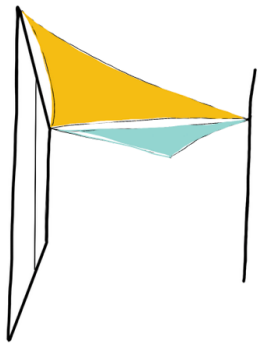

Function: Shade and Identity

Material: Fabric attached to poles and buildings.

Gives users a break from the sun, while also showing the colourful identity of the place.

VEGETATION

PLANTERS

Fast growing and resistant perennials to punctuate mineral spaces

- 1) *Salvia regia*
- 2) *Gomphrena globosa*
- 3) *Sedum palmeri*

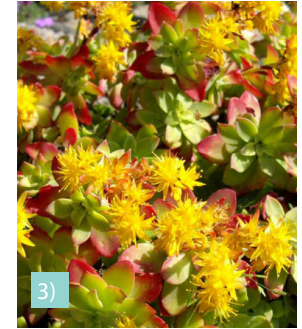
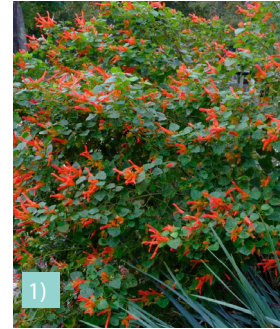

BANK

Drought tolerant plants that can sustain inondation and heat

- 4) *Asclepias mexicana*
- 5) *Salix bonplandiana*
- 6) *Acacia farnesia*

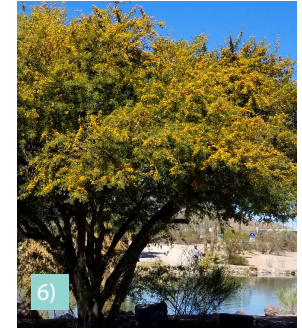

TREES

Planting for long term shade, stabilisation and biodiversity

- 7) *Guaiaacum coulteri*
- 8) *Schinus molle*
- 9) *Juniperus deppeana*

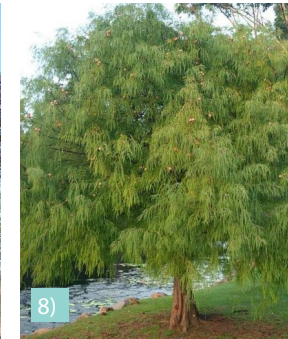

LONG-TERM PLAN

Tactical urbanism is just the first step to reach the potential of what we envision. Santa Rosa Jáuregui's municipality should act upon the remaining challenges to bring this space to its full potential.

PHASE 1

Tactical urbanism.

Our proposition is one of many possible options that can be envisioned. This is a place for experimentation that will directly serve the users of the space. They need to be the initiators of this process in order to properly respond to their needs.

PHASE 2

Funding from the CETRAM of Santa Rosa will help bring access to amenities/facilities. We hope to find bathrooms, water fountains, as well as a security, office and managing area. Some permanent street furniture could also be part of the second phase of the transformation to anchor the results of PHASE 1.

Cleaning the ancient river will give people a way to solidify their connexion with nature. This oasis will become part of the new central node.

PHASE 3

The third and ultimate phase will connect the main attractions of Santa Rosa Jáuregui into a walkable and green network. This will become possible as the trees planted in PHASE 1 grow along the river and by the streets.

A new passage, extending the Morales street to the North by passing over the river, will anchor the interventions to the fabric of the city.

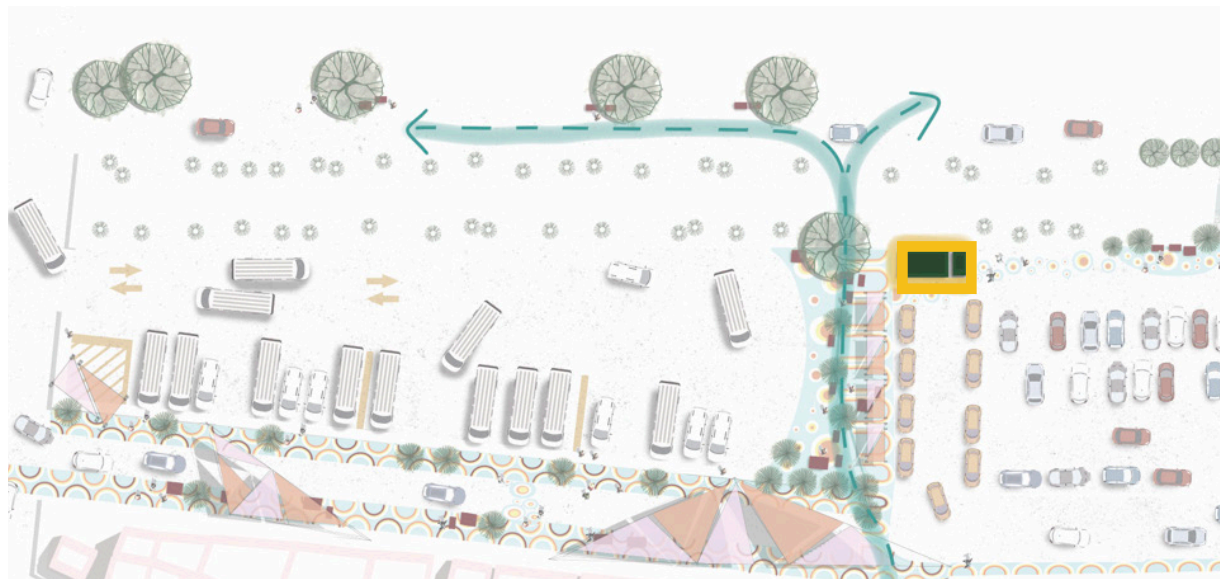



We believe the space has all the strengths it needs to become a safe and pleasant environment. With the mountain and the canal noticeable from the site and the dynamic brought by the market, this transport node could be transformed into a new centrality. Indeed, looking further, this pivotal point in Queretaro could be part of a network, linking all the cultural markers of the city, and both sides of the ancient river. The redevelopment of this space would be environmentally, economically, and socially beneficial.

We wish, most of all, to inspire the community to act. They are the key factor for the well-being of the community. Our proposal is simply the spark that forecasts a brighter future in the community of Santa Rosa Jauregui.