

WELC



ME

STREET

INTERNATIONAL PROYECT  
MONTREAL, CANADA  
2023



# GEOGRAPHIC CONTEXT

## GEOGRAPHIC LOCATION OF CANADA



## LOCATION OF QUEBEC



## LOCATION OF MONTREAL

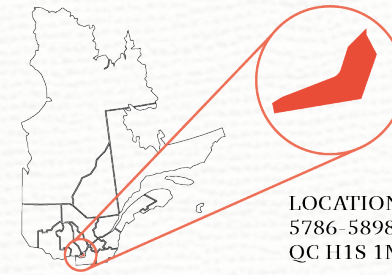

LOCATION;  
5786 - 5898 Rue Jean-Talon E, Saint-Léonard,  
QC H1S 1M2, Canada

## VEGETATION

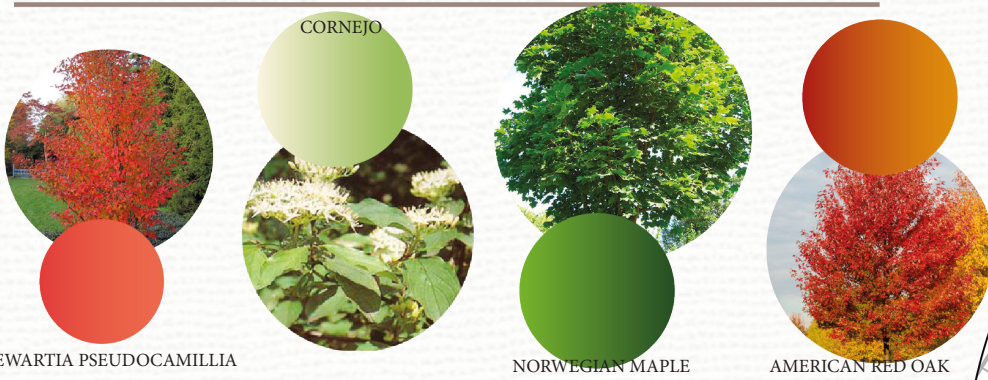

STEWARTIA PSEUDOCAMILLIA

CORNEJO

NORWEGIAN MAPLE

AMERICAN RED OAK

## ANNUAL WEATHER

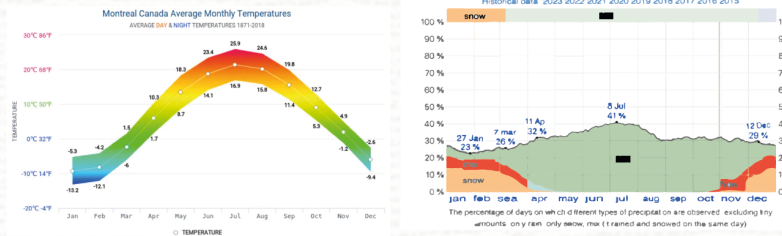

## ANNUAL SUNSHINE PASSAGE.

HALF DAY

WINTER

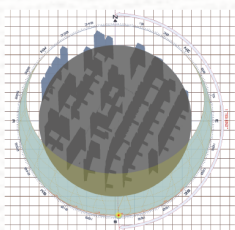

AUTUMN

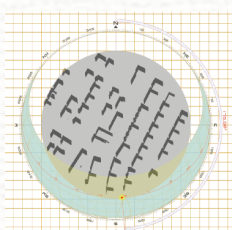

SUMMER

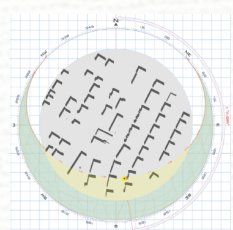

SPRING

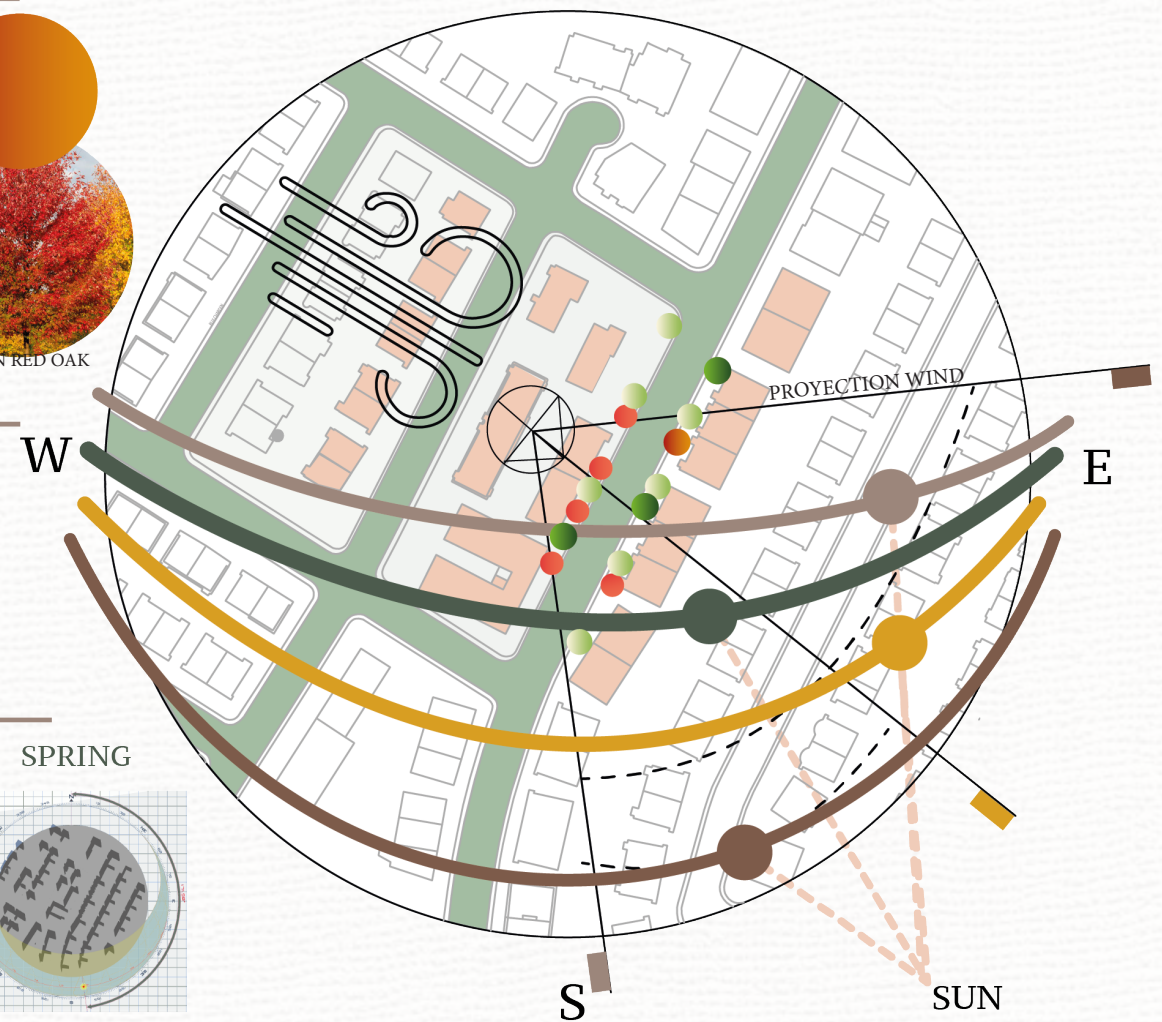
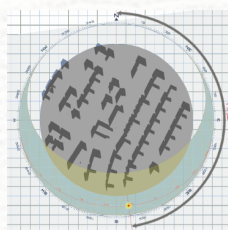



# URBAN CONTEXT

4 to 6 meters front setback

Vertical mixity: Commercial ground floor and residential at the upper floors

Hotel

On street parking available on both sides



Vertical mixity: Commercial ground floor and residential

- TRANSIT CARS LINE
- PEDESTRIAN LINE
- SUBWAY LINE
- DESING AREA



## EXISTING FURNITURE

- BUS STOP
- SUBWAY STATION
- TRAFFIC LIGHTS
- TREE'S AND GREEN AREAS
- PUBLIC LIGHT'S
- PUBLIC TRASH CANS
- PUBLIC BENCHES

Three (3) storeys buildings





## POPULATION

### POPULATION DENSITY

2 029 379 habitants



### LOCAL ECONOMY

Tourism



Trade

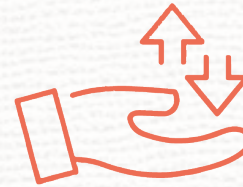

Service



Mini-supermarkets



2 029 379 habitants

### AGE RANGE

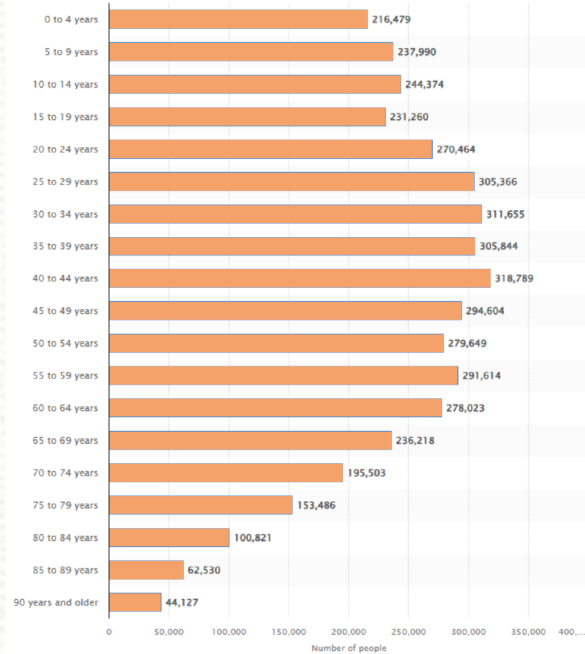

## PROBLEMATIC

In Montreal, Canada, there are two extremes of climate throughout the year: in the summer, temperatures are above 40 degrees Celsius, and in the winter, freezing temperatures of up to 2 degrees Celsius, in addition to trying to improve social cohesion in the environment, due to temperature changes and the lack of aesthetics in terms of mobility and spaces that help to mitigate the temperatures in both cases.





## CONCEPT

Social interaction of the muticultures that exist in the area in a single point through means and solutions of heat mitigation of the area, making it attractive, aesthetic, fresh and healthy for the social interaction and occupation time of our users.

### GUIDING ELEMENTS



Attraction



Social interaction



Belonging

### JUSTIFICACIÓN

This project arises from the idea of the unification of cultures since, we have found that in this part of the city there are different nations living together, from the Italian

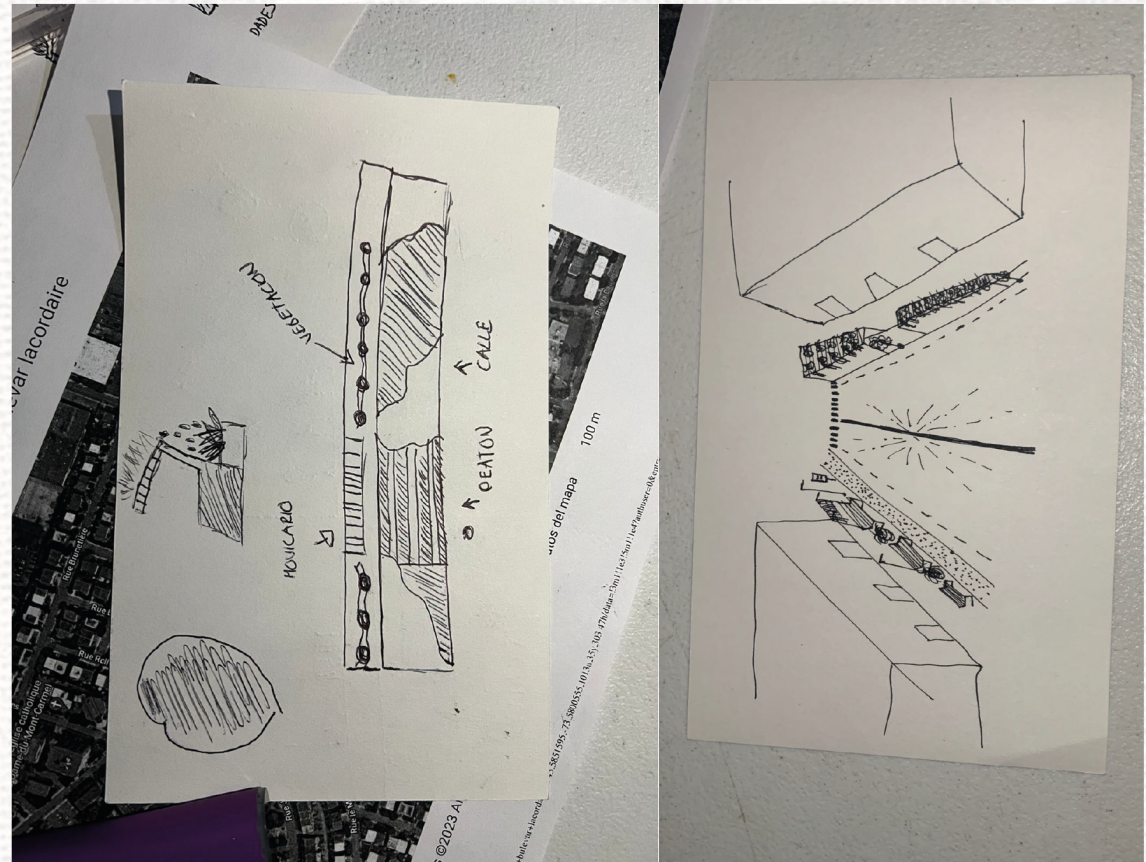



# ARCHITECTURAL PROPOSAL



Planta Baja



URBAN MOVILIARY

WOOD TREE      COMUNIATION SPACES      PUBLIC BENCHES

URBAN MOVILIARY

COLOR PALLETE

#E60000	#00AEEF	#FFD700	#D4AF37	#FF0000
---------	---------	---------	---------	---------



# ARCHITECTURAL CUTS

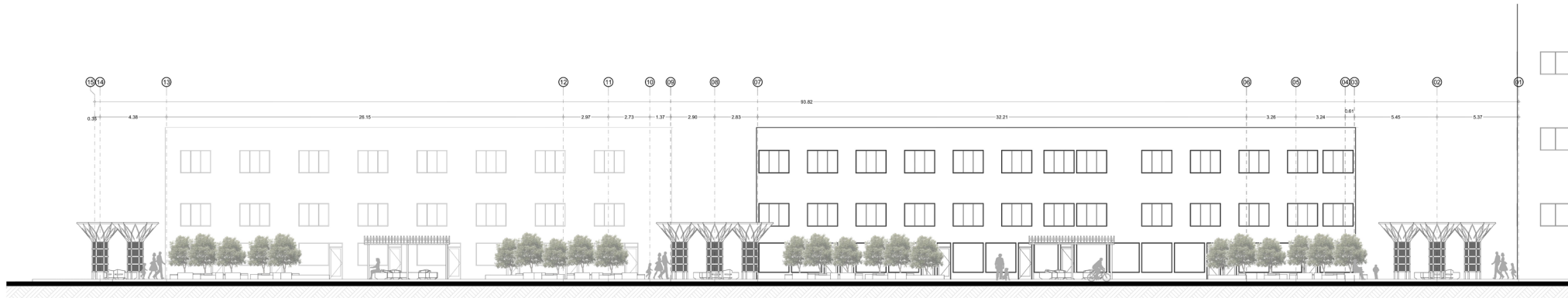

F-01

FACHADA NORPONIENTE

1:125



F-02

FACHADA SURESTE

1:125



# PROPOSAL









